

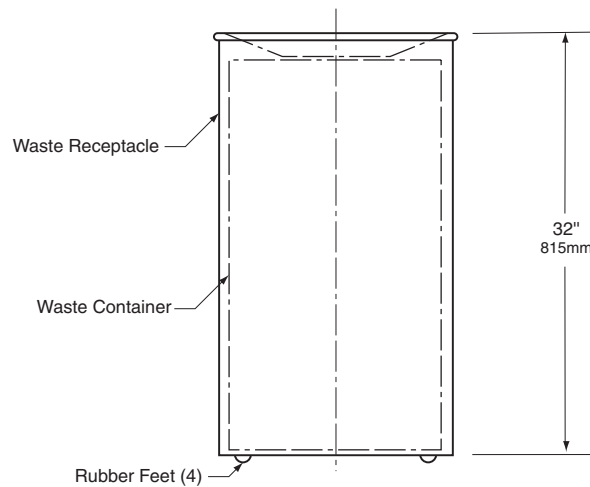

Technical Data

Floor Standing Large Capacity Waste Receptacle
B2400

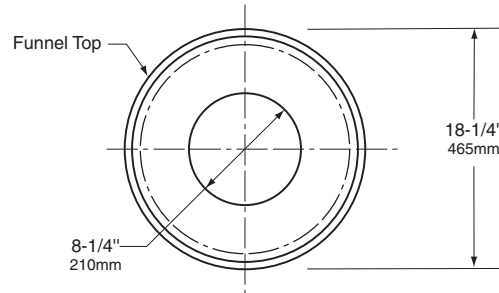

MATERIALS:

Waste Receptacle — 18-8 S, type-304, 16-gauge (1.6mm) stainless steel with satin finish. All-welded construction. 1/2" (13mm) recessed bottom equipped with four 1-1/2" (40mm) diameter x 3/4" (19mm) high, heavy-duty rubber feet.

Funnel Top — 18-8 S, type-304, 16-gauge (1.6mm) stainless steel with satin finish. One-piece construction. 8-1/4" (210mm) diameter opening.

Waste Container — Galvanized steel with wire handle. Removable for servicing. Capacity: 33-gal. (125-L).

OPERATION:

Funnel top lifts off for removal and servicing of waste container. Wide opening provides hygienic, no-touch waste disposal. Heavy-duty rubber feet protect flooring and elevate receptacle slightly off the floor.

Designer's Note: This unit is not suitable for outside use.

SPECIFICATION:

Floor-standing waste receptacle shall be type-304, 16-gauge (1.6mm) stainless steel with satin finish. One-piece funnel top shall have 8-1/4" (210mm) diameter opening. Bottom of receptacle shall be recessed 1/2" (13mm) and equipped with four heavy-duty rubber feet that elevate receptacle slightly off floor. Removable, galvanized-steel waste container shall have a wire handle and a minimum capacity of 33-gal. (125-L).

Floor-Standing Waste Receptacle shall be Model B-2400 of Bobrick Washroom Equipment, Inc., Clifton Park, New York; Jackson, Tennessee; Los Angeles, California; Bobrick Washroom Equipment Company, Scarborough, Ontario; Bobrick Washroom Pty, Ltd., Australia; and Bobrick Washroom Limited, United Kingdom.

The illustrations and descriptions herein are applicable to production as of the date of this Technical Data Sheet. The manufacturer reserves the right to, and does from time to time, make changes and improvements in designs and dimensions.

Revised 5/06